

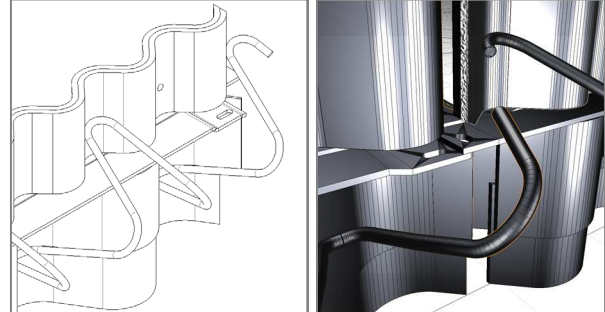

From now you receive the new version of Cosinus Slide® Joint, with the following features:

- New and simplified profile connection system:
 - Precise connection of profiles
 - Faster installation
 - Reduced waste material
- Enhanced system-stiffness:
 - Improved weldings
 - More compact design
 - Significant reduction of bending and rocking
- Enlarged adjustment plate for the console profiler
- Again improved load transfer capacity:
 - The load transfer capacity is positively influenced by the changes made
 - The capacity reserves allow partial optimization of the industrial floor



The visible surface of the Cosinus Slide® joint remains unchanged, as well as the associated already well known advantages:

- Vibration and impact-free joint-crossing with all common tire types is possible.
- Proof of compliance with the EU Directive 2002/44/EC on the minimum health and safety requirements regarding the exposure of workers to the risks arising from physical agents (vibration)
- Structural design of the various loads and combinations for each of your projects - free of charge.

Do not settle any longer with a doweled system or a “heavy duty joint” without proof!

Go for the state of the art in jointing solutions!

You and your industrial floor deserve better...

